

FIESTA / OPERA ASSEMBLY WITH CLASSIC LADDER

Contents of Fiesta box # 1001 or Opera # 1016

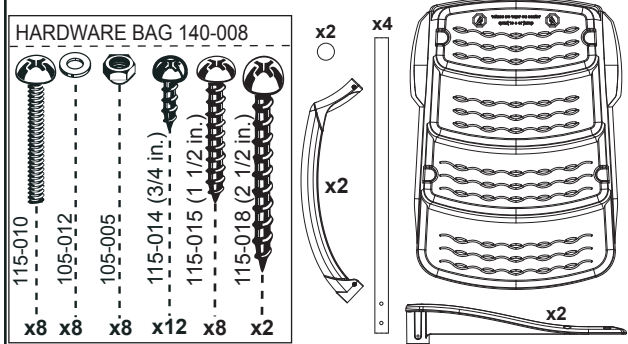

Contents of the ladder box SKU # 6001

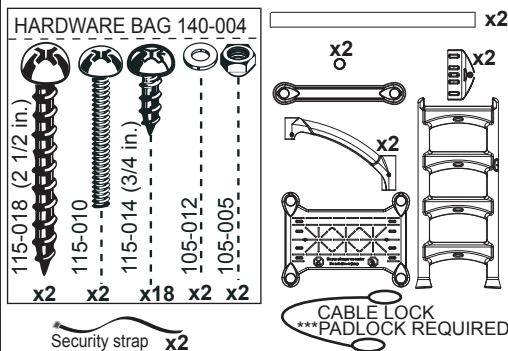

Sand (not included)



WARNING

- ◆ Do not dive or jump from step or ladder.
- ◆ Use BATTERY operated tools to avoid electric shocks.
- ◆ Install step on flat surface, following the manufacturers instructions.
- ◆ Remove step from pool during freezing climate season.
- ◆ Manufacturer cannot be held responsible for injuries caused by abusive use of product.
- ◆ Ask your city about specific regulations that apply to your above-ground pool and ladder.

Tools Required

(not included)

A weather resistant padlock is recommended.

Maximum functional width is 1/4 inch.

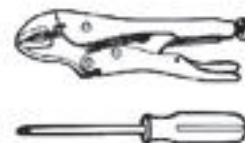
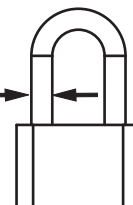

Fiesta-Classic shown.
Instructions also compatible for Opera-Classic



A

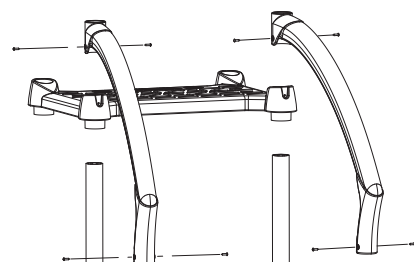
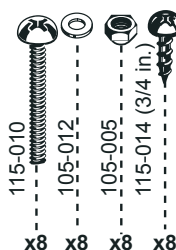

1) Insert the four posts into the post ends and secure them in place with the screws provided.

2) Insert the platform over the 2 rear posts. Do not secure yet.

3) Insert the large handrails securing them with the screws provided.

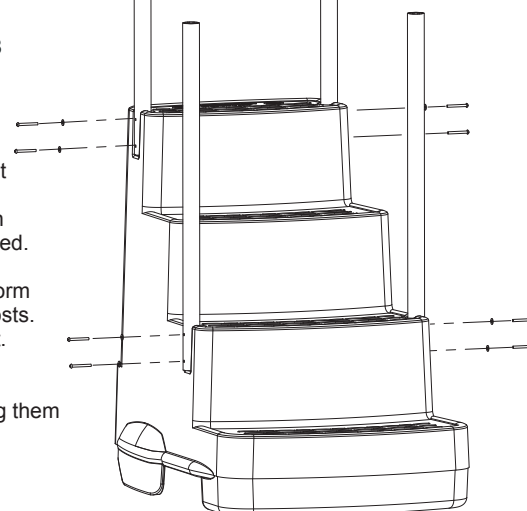

B

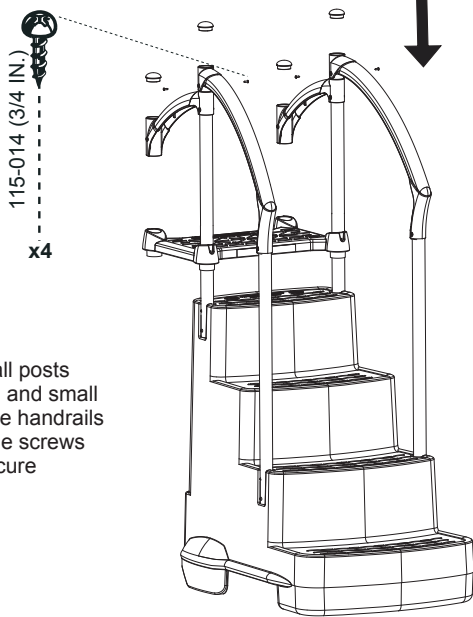

1) Install the four post covers.

2) Slide the two small posts through the platform and small handrails. Secure the handrails to the posts using the screws provided. Do not secure platform.

D

WARNING

To prevent a pool liner puncture, keep a minimum of 1" inch gap between the pool liner and the rear underside of the step.

1) Slowly submerge the Step in the pool. Make sure you do not damage the liner in the process.

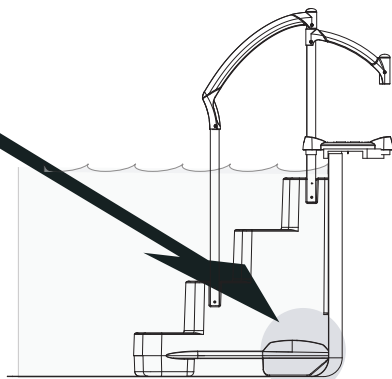

C

1) Insert the sandbag under the first step.

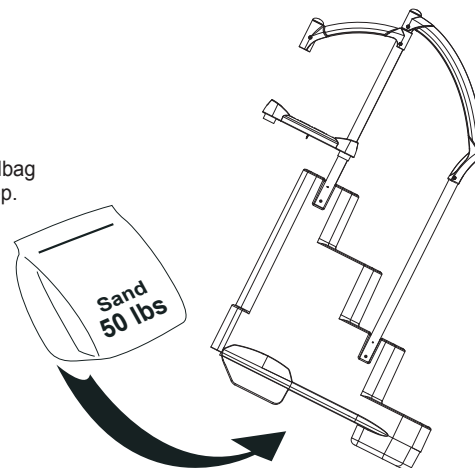

E

1) Slowly submerge the Step in the pool. Make sure you do not damage the liner in the process.

2) Once the step is in the pool secure the platform to the top seat (see illustration) using the two straps provided.

Security strap x2

OPTIONAL:

Once the pool step has been completely assembled and secured to the pool, attach the 2 screws supplied through the platform to the top seat of your pool to provided a more rigid assembly.

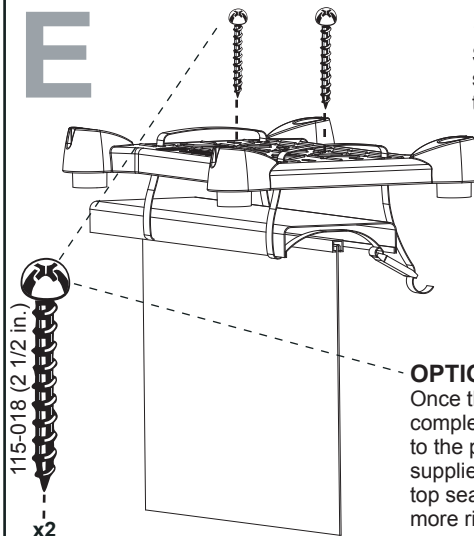

F

1) Assemble the two posts through the platform and small handrails. Slide the pivot blocks onto the posts and secure at 40 1/4 inches from the bottom of the posts with screws provided.

2) Attach the ladder to the pivot blocks with the bolts, washers and nuts provided.

3) Finish the assembly by securing the platform and ladder base to the posts with the screws provided.

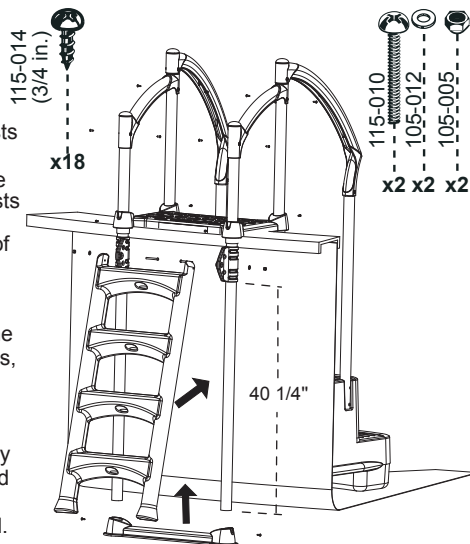

G

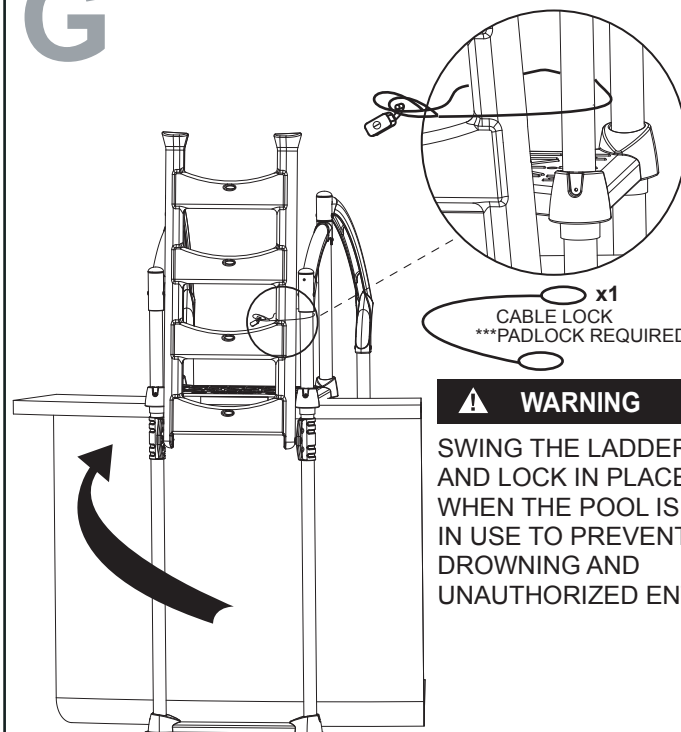

WARNING

SWING THE LADDER UP AND LOCK IN PLACE WHEN THE POOL IS NOT IN USE TO PREVENT DROWNING AND UNAUTHORIZED ENTRY.

InnovaPlas
The pool Step Company

370 Lajeunesse St,
St-Jérôme (Québec),
Canada J7Y4E5



MANUFACTURER WARRANTY

1 Year on the step and ladder.

1 year on the hardware.